

TECHNICAL DATAS *1500 Short 22 B-C*

MODEL :

Brick version : C1500B22
Refractory concrete : C1500C22

MATERIALS :

Refractory brick
Refractory concrete
Reinforced with metal fibres

PARTS :

The hearthstone : 3 parts
The oven arch : 3 parts
The arch

CARACTERISTICS :

Cooking chamber : 0.92 m²
Weight : 533 kg

POWER USED :

Pre-firing : 8 kg Wood/Hour (20% dampness) = 32.5 kW/Hour
Cooking with the door opened : 4 kg Wood/Hour (20% dampness) = 16.3 kW/Hour

Power going through the sides with the advised insulation : 0.97 KW/Hour
Radiation power (through the door) : 1.9 KW/Hour

Fresh air consumption : 240 m³/Hour at 20 °C
Minimal smoke pipe : Height 3 m- Part 195 cm²-Diameter 180 mm

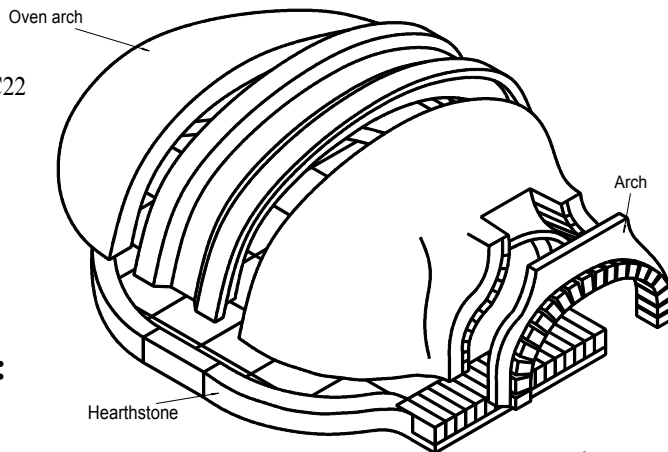

Flue connector in conformity with standard LN1856-2

Smoke temperature :

For oven stoves : 175°C

Maximum temperature for the use of the oven :
500 °C

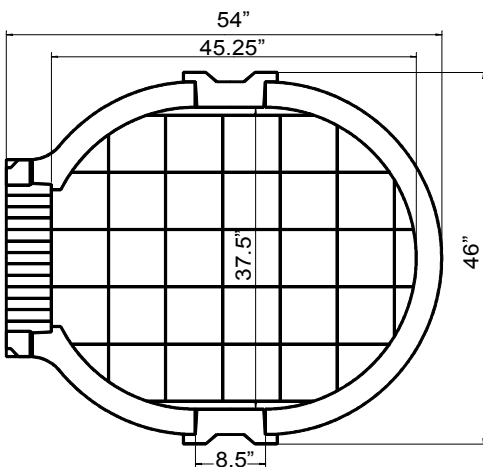
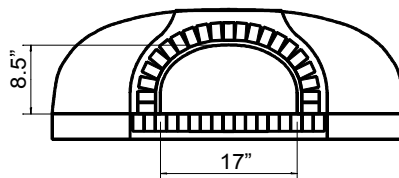
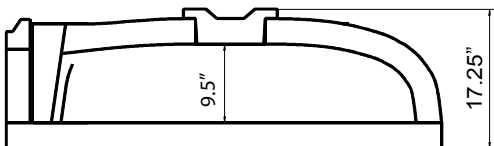

EQUIPMENT

Steel insulation door AC1R
External door AC6

Flue connector AC99 or AC99SC
Vault thermometer AC20